



**32 Lobelia Crescent,  
Casuarina**

**4** | **2** | **4**  
Beds | Baths | Cars

Single level Coastal Luxury with Massive  
4 Car Garage

**McGrath**

# Frequently Asked Questions

REASON FOR SELLING	Relocating
TOTAL AREA	685 sqmn 330 sqm under roof
YEAR BUILT	2014
BUILDERS NAME	Metricon
CAR SPACES	4 car oversized garage (W - 6.4m x L - 11.9m x H - 4.0m)
DATE OF PURCHASE	April 2018
OWNER OCCUPIED/TENANTED	Owner occupied
KITCHEN	<ul style="list-style-type: none"><li>• Induction cooktop with 6 burners</li><li>• 900mm oven</li></ul>
SOLAR & HOT WATER SYSTEM	18 panels total with 2 panels for hot water system (with electric booster)
AIR CONDITIONING	Yes - ducted air-conditioning 2 x Split system air-conditioning in the garage
WATER TANK	Yes
BODY CORP RATES	Yes saltwater pool (9m x 4.5m)
INTERNET	NBN (Available)
COUNCIL RATES	\$4,963 Per annum (Approximately)
RENTAL ESTIMATE	\$1,300 to \$1,400 per week (approximately)
SECURITY AND ALARM SYSTEM	Yes - Crimsafe doors installed & alarm system
INCLUSIONS	Four shelves in the garage, a bookshelf in the garage, a TV mounted on the wall in the garage, and a bar fridge with bar also located in the garage. One wall-mounted TV in the media room.
BUILDING AND PEST AVAILABE	No
SCHOOL CATCHMENT	<ul style="list-style-type: none"><li>• Kingscliff High School - 2.7km away</li><li>• Kingscliff Public School - 3.5km away</li><li>• St Anthony's Primary School - 3.7km away</li><li>• Lindisfarne Anglican Grammer School - 18km away</li></ul>
IS THERE ANYTHING IN THE PROPERTY THAT DOES NOT WORK	Light on exhaust in kitchen



# Recent Comparable Sales

14 Banzai Street,  
Kingscliff

4	3	2
Beds	Baths	Cars

**Sale price**  
\$2,670,000

**Sale date**  
Nov 2025

**Land & internal size**  
525m2 ext., 332m2 internal



8 Vanda Lane,  
Casuarina

4	3	2
Beds	Baths	Cars

**Sale price**  
\$2,525,000

**Sale date**  
August 2025

**Land & internal size**  
721m2 ext., 236m2 internal



411 Casuarina Way,  
Casuarina

5	3	3
Beds	Baths	Cars

**Sale price**  
\$2,560,000

**Sale date**  
July 2025

**Land & internal size**  
645m2 ext., 320m2 internal



# McGrath

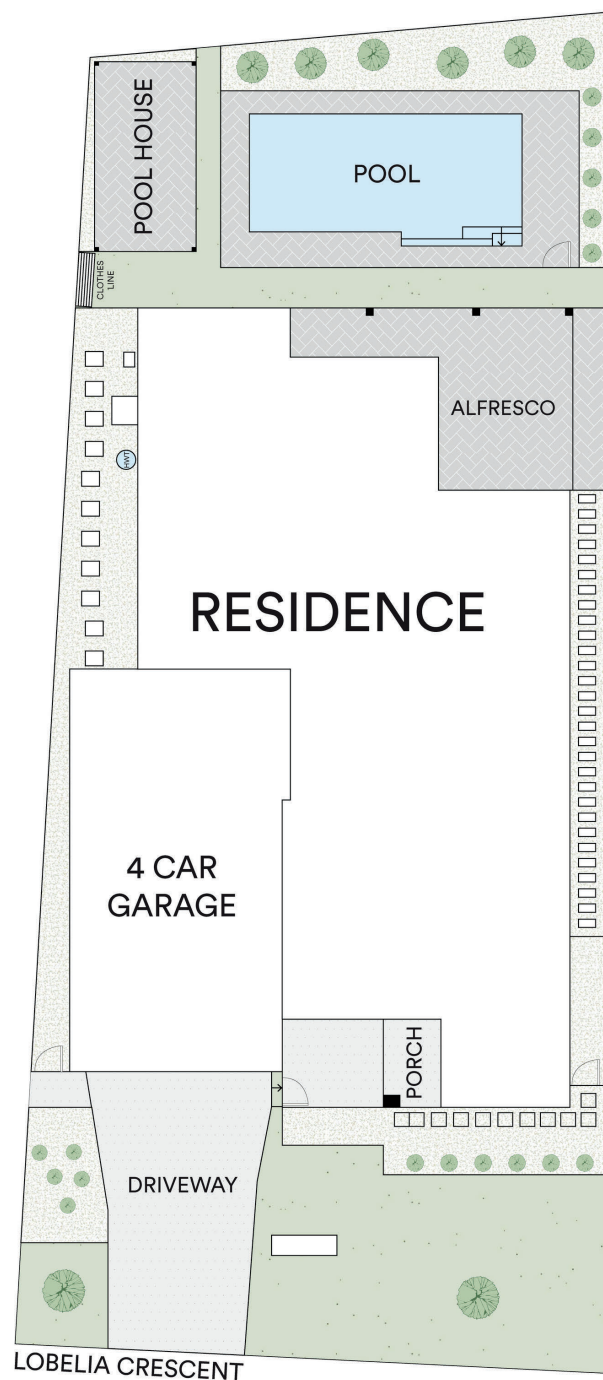

## A portrait of a man with short brown hair and glasses, smiling. He is wearing a brown textured blazer over a black t-shirt. He is sitting in a modern chair with a light-colored wooden backrest. The background is a bright, out-of-focus interior space with large windows and a white wall.



Floorplan and dimensions are indicative only.